

## TOP ENTRY 2-PORT MODULAR PCB JACK WITH METAL PEGS 6P PROFILE=16.00MM (UNSHIELDED)

### SPECIFICATIONS

**Insulation Resistance:** 500MΩ Min.  
**Contact Resistance:** 20mΩ Max.  
**Rating Current:** 1.5A Max.  
**Rating Voltage:** 120V AC.  
**Dielectric Voltage:** 1000 Vrms 60 Sec. Min.  
**Temperature Range:** -40°C / +85°C  
**Durability:** 500 Mating cycles Min.

### MATERIALS

**Housing:** PBT Glass Filled (UL 94V-0)  
**Soldering Temperature:** 235°C  
**Color:** Gray  
**Spring Wire:** Phosphor Bronze  
 Gold plating Over Nickel  
**All materials must be RoHS compliant.**

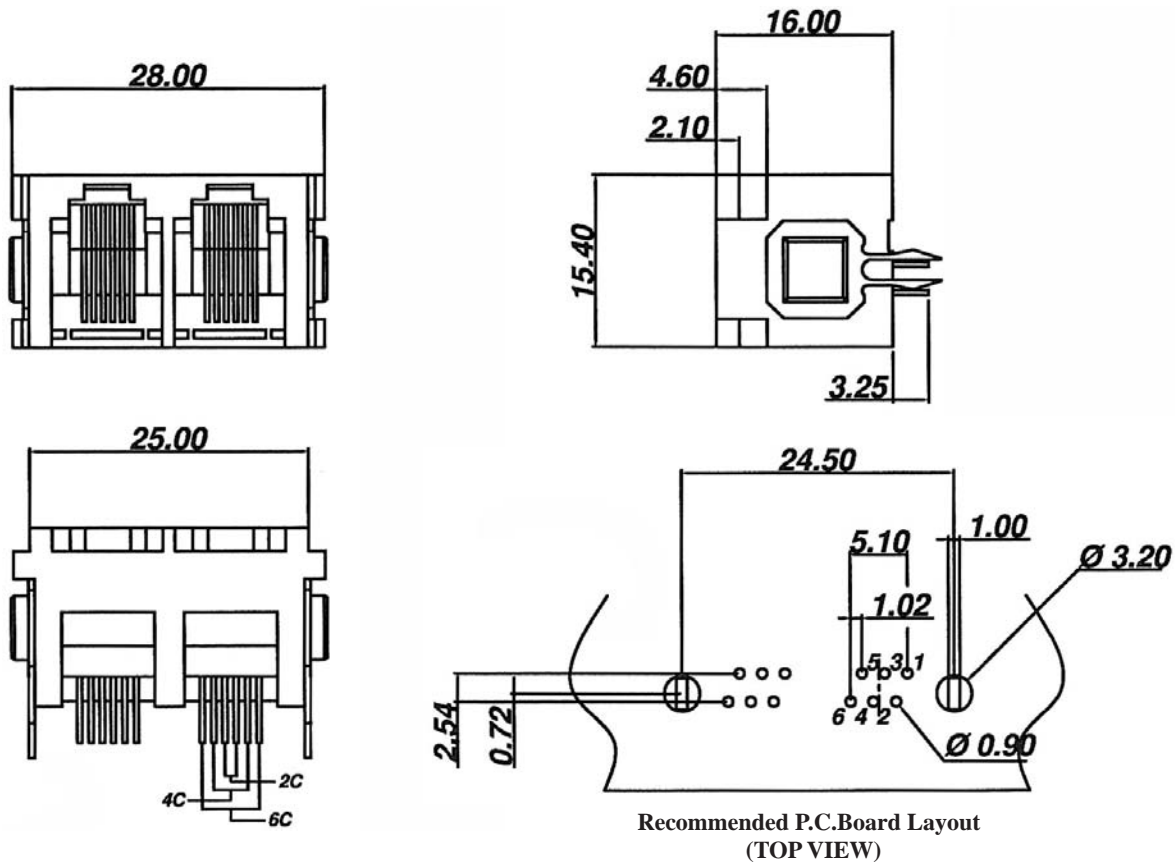

### ORDERING INFORMATION:

P/N MJ 6 2 -  $\frac{x}{1}$   $\frac{x}{2}$   $\frac{x}{3}$   $\frac{A}{4}$  0 2

- NO. OF POSITIONS & CONTACTS:  
 "66" 6P6C  
 "64" 6P4C
- CONTACT FINISH:  
 "A" 6 MICROINCH GOLD  
 "B" 15 MICROINCH GOLD  
 "C" 30 MICROINCH GOLD  
 "D" 50 MICROINCH GOLD
- COLOR OF HOUSING:  
 "A" GRAY
- NO. OF PORTS:  
 02

## TOP ENTRY 3-PORT MODULAR PCB JACK WITH METAL PEGS 6P PROFILE=16.00MM (UNSHIELDED)

### SPECIFICATIONS

**Insulation Resistance:** 500MΩ Min.  
**Contact Resistance:** 20mΩ Max.  
**Rating Current:** 1.5A Max.  
**Rating Voltage:** 120V AC.  
**Dielectric Voltage:** 1000 Vrms 60 Sec. Min.  
**Temperature Range:** -40°C / +85°C  
**Durability:** 500 Mating cycles Min.

### MATERIALS

**Housing:** PBT Glass Filled (UL 94V-0)  
**Soldering Temperature:** 235°C  
**Color:** Black  
**Spring Wire:** Phosphor Bronze  
 Gold plating Over Nickel  
**All materials must be RoHS compliant.**

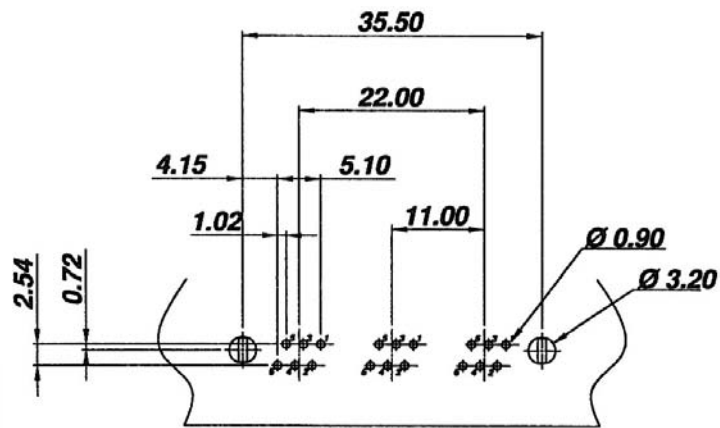
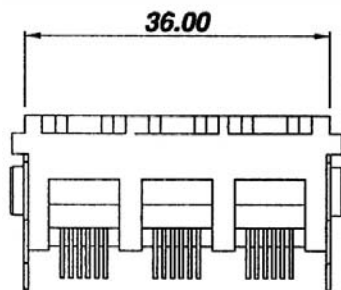
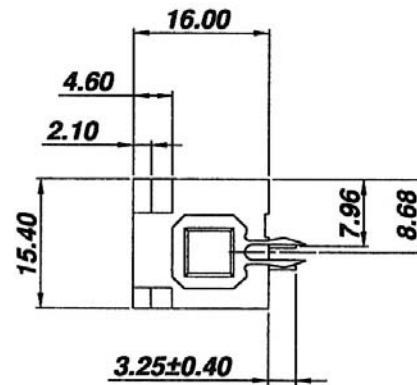
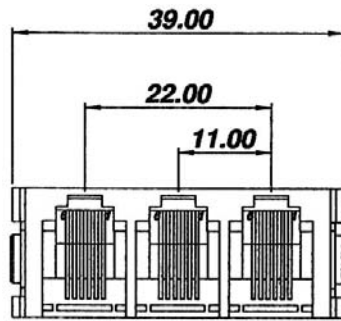

Recommended P.C.Board Layout  
(TOP VIEW)

### ORDERING INFORMATION:

P/N MJ62 -  $\frac{x}{1} \frac{x}{2} \frac{x}{3} B 03$

1. NO. OF POSITIONS & CONTACTS:  
 "66" 6P6C  
 "64" 6P4C
2. CONTACT FINISH:  
 "A" 6 MICROINCH GOLD  
 "B" 15 MICROINCH GOLD  
 "C" 30 MICROINCH GOLD  
 "D" 50 MICROINCH GOLD
3. NO. OF PORTS:  
 03

NOTE: P/N MJ62HT-xxxB03 for High Temp. Version

## TOP ENTRY 4-PORT MODULAR PCB JACK WITH METAL PEGS 6P PROFILE=16.00MM (UNSHIELDED)

### SPECIFICATIONS

**Insulation Resistance:** 500MΩ Min.  
**Contact Resistance:** 20mΩ Max.  
**Rating Current:** 1.5A Max.  
**Rating Voltage:** 120V AC.  
**Dielectric Voltage:** 1000 Vrms 60 Sec. Min.  
**Temperature Range:** -40°C / +85°C  
**Durability:** 500 Mating cycles Min.

### MATERIALS

**Housing:** PBT Glass Filled (UL 94V-0)  
**Soldering Temperature:** 235°C  
**Color:** Black  
**Spring Wire:** Phosphor Bronze  
 Gold plating Over Nickel  
**All materials must be RoHS compliant.**

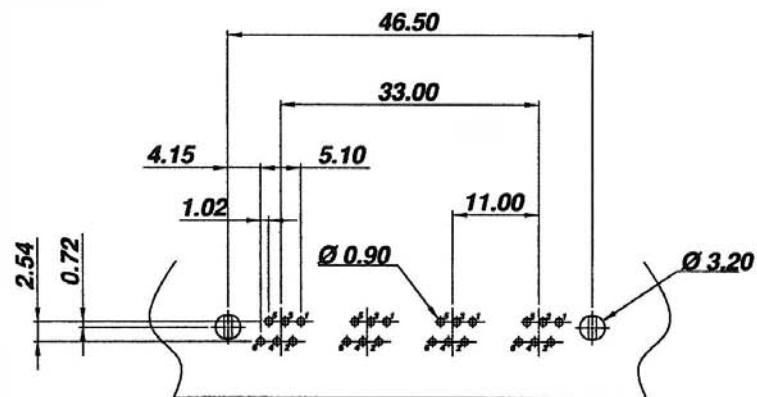
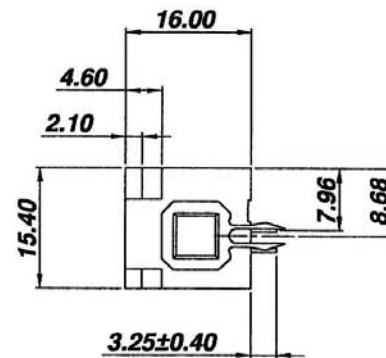
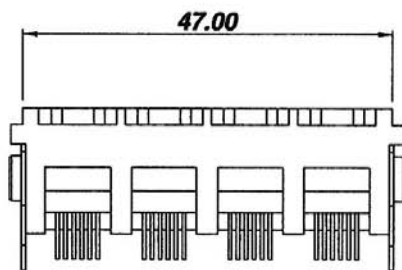
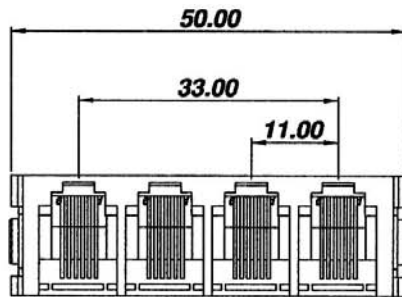

Recommended P.C.Board Layout  
(TOP VIEW)

### ORDERING INFORMATION:

P/N MJ62 -  $\frac{x}{1} \frac{x}{2} \frac{x}{3} B \frac{0}{3} 4$

1. NO. OF POSITIONS & CONTACTS:  
 "66" 6P6C  
 "64" 6P4C
2. CONTACT FINISH:  
 "A" 6 MICROINCH GOLD  
 "B" 15 MICROINCH GOLD  
 "C" 30 MICROINCH GOLD  
 "D" 50 MICROINCH GOLD
3. NO. OF PORTS:  
 04

NOTE: P/N MJ62HT-xxxB04 for High Temp. Version

## TOP ENTRY 5-PORT MODULAR PCB JACK WITH METAL PEGS 6P PROFILE=16.00MM (UNSHIELDED)

### SPECIFICATIONS

**Insulation Resistance:** 500MΩ Min.  
**Contact Resistance:** 20mΩ Max.  
**Rating Current:** 1.5A Max.  
**Rating Voltage:** 120V AC.  
**Dielectric Voltage:** 1000 Vrms 60 Sec. Min.  
**Temperature Range:** -40°C / +85°C  
**Durability:** 500 Mating cycles Min.

### MATERIALS

**Housing:** PBT Glass Filled (UL 94V-0)  
**Soldering Temperature:** 235°C  
**Color:** Black  
**Spring Wire:** Phosphor Bronze  
 Gold plating Over Nickel  
**All materials must be RoHS compliant.**

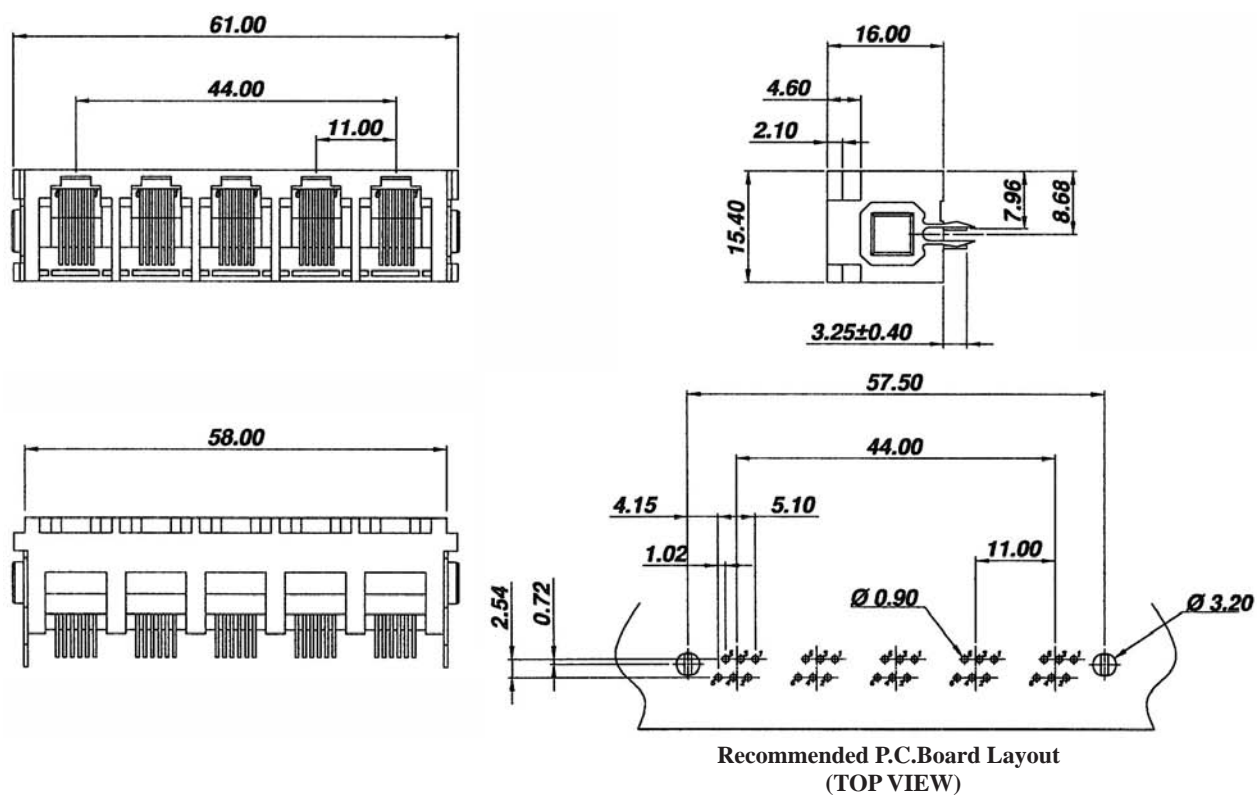

### ORDERING INFORMATION:

P/N MJ62 -  $\frac{x}{1} \frac{x}{2} \frac{x}{3} B \frac{0}{3} 5$

1. NO. OF POSITIONS & CONTACTS:  
 "66" 6P6C  
 "64" 6P4C
2. CONTACT FINISH:  
 "A" 6 MICROINCH GOLD  
 "B" 15 MICROINCH GOLD  
 "C" 30 MICROINCH GOLD  
 "D" 50 MICROINCH GOLD
3. NO. OF PORTS:  
 05

NOTE: P/N MJ62HT-xxxB05 for High Temp. Version

## TOP ENTRY 6-PORT MODULAR PCB JACK WITH METAL PEGS 6P PROFILE=16.00MM (UNSHIELDED)

### SPECIFICATIONS

**Insulation Resistance:** 500MΩ Min.  
**Contact Resistance:** 20mΩ Max.  
**Rating Current:** 1.5A Max.  
**Rating Voltage:** 120V AC.  
**Dielectric Voltage:** 1000 Vrms 60 Sec. Min.  
**Temperature Range:** -40°C / +85°C  
**Durability:** 500 Mating cycles Min.

### MATERIALS

**Housing:** PBT Glass Filled (UL 94V-0)  
**Soldering Temperature:** 235°C  
**Color:** Gray  
**Spring Wire:** Phosphor Bronze  
 Gold plating Over Nickel  
**All materials must be RoHS compliant.**

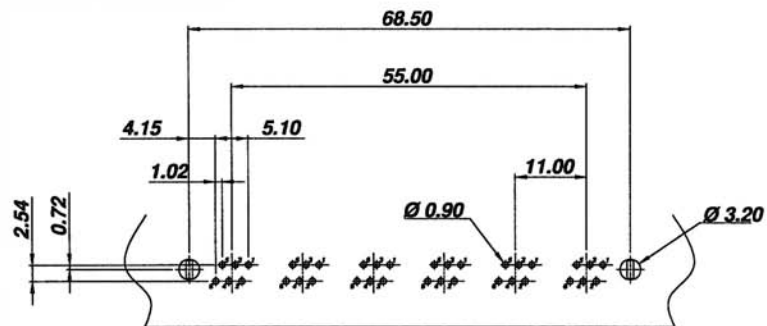
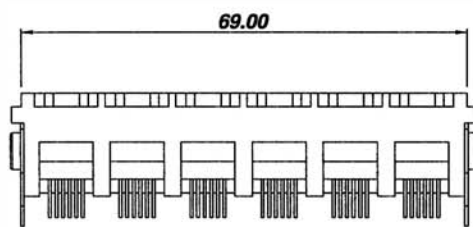
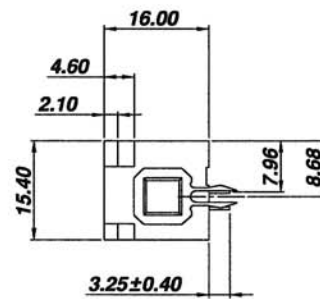
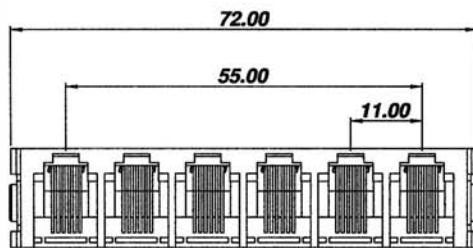

Recommended P.C.Board Layout  
(TOP VIEW)

### ORDERING INFORMATION:

P/N MJ62 -  $\frac{x}{1} \frac{x}{2} \frac{x}{3} \frac{A}{4} 06$

1. NO. OF POSITIONS & CONTACTS:  
 "66" 6P6C  
 "64" 6P4C
2. CONTACT FINISH:  
 "A" 6 MICROINCH GOLD  
 "B" 15 MICROINCH GOLD  
 "C" 30 MICROINCH GOLD  
 "D" 50 MICROINCH GOLD
3. COLOR OF HOUSING:  
 "A" GRAY
4. NO. OF PORTS:  
 06

NOTE: P/N MJ62HT-6xxA06 for High Temp. Version

## TOP ENTRY 8-PORT MODULAR PCB JACK WITH METAL PEGS 6P PROFILE=16.00MM (UNSHIELDED)

### SPECIFICATIONS

**Insulation Resistance:** 500MΩ Min.  
**Contact Resistance:** 20mΩ Max.  
**Rating Current:** 1.5A Max.  
**Rating Voltage:** 120V AC.  
**Dielectric Voltage:** 1000 Vrms 60 Sec. Min.  
**Temperature Range:** -40°C / +85°C  
**Durability:** 500 Mating cycles Min.

### MATERIALS

**Housing:** PBT Glass Filled (UL 94V-0)  
**Soldering Temperature:** 235°C  
**Color:** Black  
**Spring Wire:** Phosphor Bronze  
 Gold plating Over Nickel  
**All materials must be RoHS compliant.**

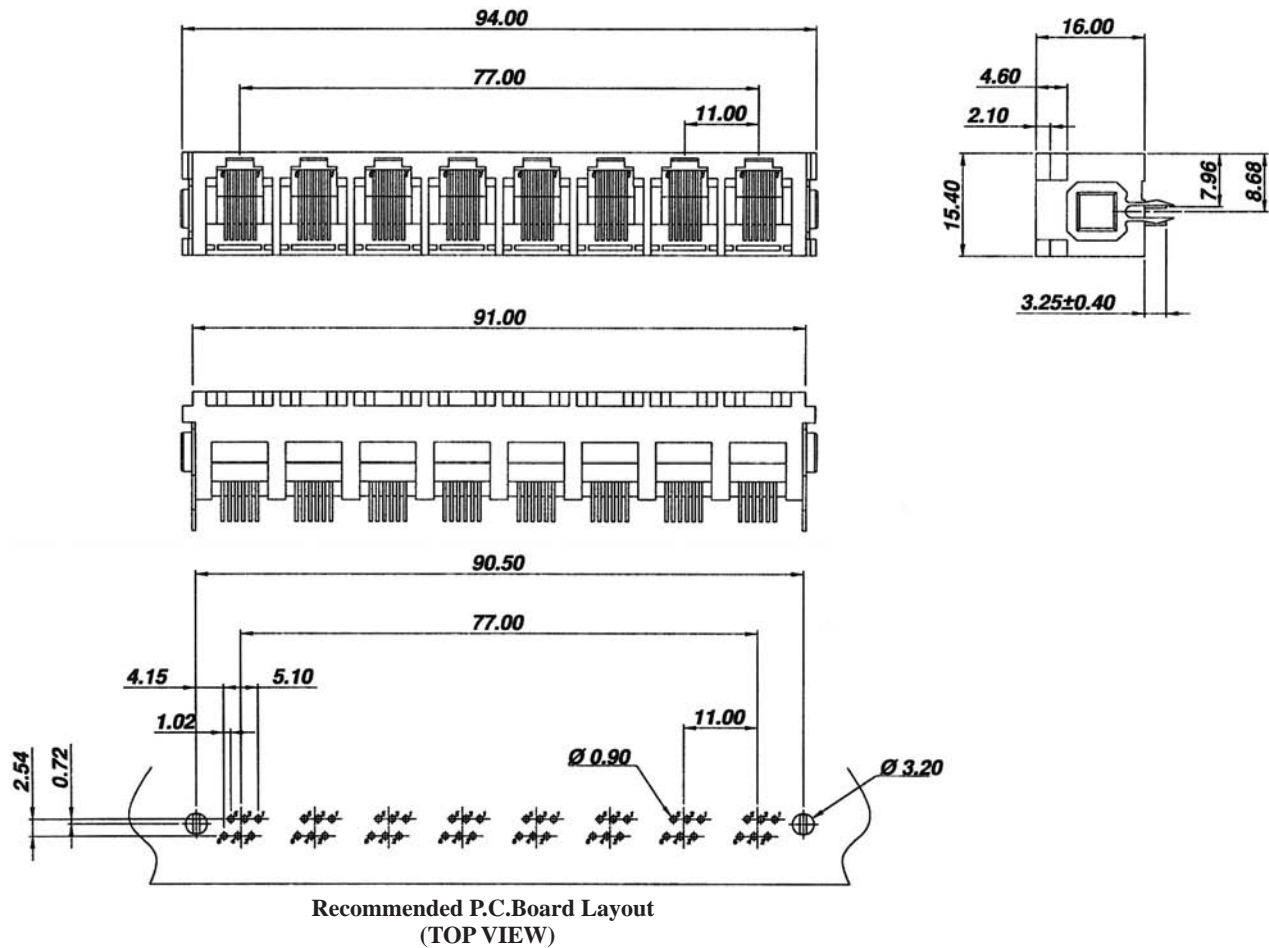

### ORDERING INFORMATION:

P/N MJ62 -  $\frac{x}{1} \frac{x}{2} \frac{x}{3} B 08$

1. NO. OF POSITIONS & CONTACTS:  
 "66" 6P6C  
 "64" 6P4C
2. CONTACT FINISH:  
 "A" 6 MICROINCH GOLD  
 "B" 15 MICROINCH GOLD  
 "C" 30 MICROINCH GOLD  
 "D" 50 MICROINCH GOLD
3. NO. OF PORTS:  
 08

NOTE: P/N MJ62HT-xxxB08 for High Temp. Version