

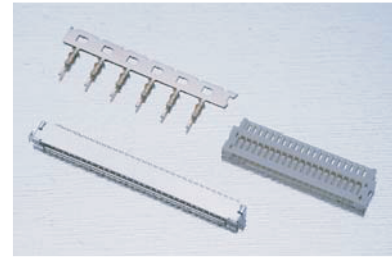

## 1.0mm TERMINAL / HOUSING / WAFER SMT R/A TYPE

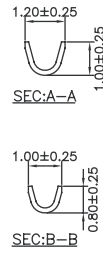
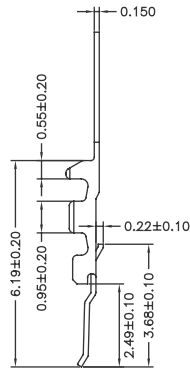
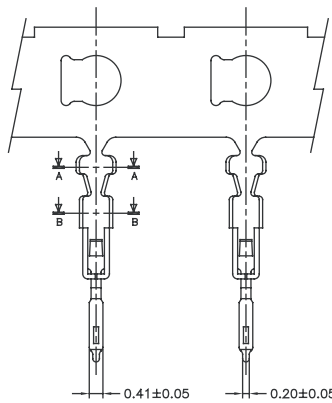

Wire Range	Insulation O.D.	Material	Finish	Qty/reel
AWG#28-#36	0.50mm(max)	Phosphor Bronze	Gold-flash	15,000pcs

**Part No.:1002-T-L**

### SPECIFICATIONS

Current Rating: 1A AC,DC  
 Voltage Rating: 100V AC,DC  
 Temperature Range: -25°C ~ +85°C  
 Contact Resistance: 20mΩ Max.  
 Insulation Resistance: 100MΩ Min.  
 Withstanding Voltage: 500V AC/minute  
 Shell: Phosphor Bronze/Nickel-plated  
 Material: Nylon 46,UL94V-0  
 Color: Natural(Beige)

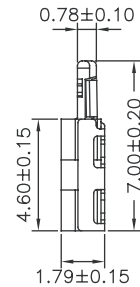
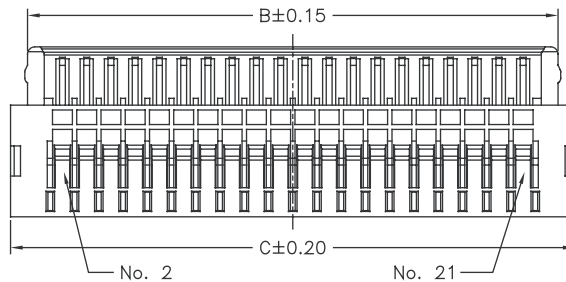
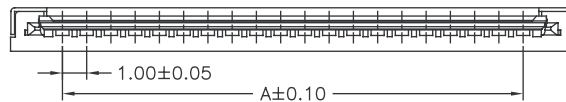

PART NO.	Dimensions		
	A	B	C
1002H-20W-U	19.00	21.88	23.28
1002H-30W-U	29.00	31.88	33.28

**Part No.:1002H-XXW-U**

### SPECIFICATIONS

Current Rating: 1A AC,DC  
 Voltage Rating: 100V AC,DC  
 Temperature Range: -25°C to +85°C  
 Contact Resistance: 20mΩ Max  
 Insulation Resistance: 100MΩ Min  
 Withstanding Voltage: 500V AC/minute  
 Shell: Brass/Tin-plated  
 Contacts: Phosphor Bronze/Tin-plated  
 Material:Nylon 6T,UL94V-0

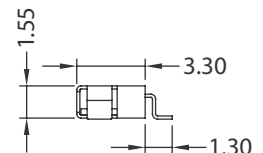
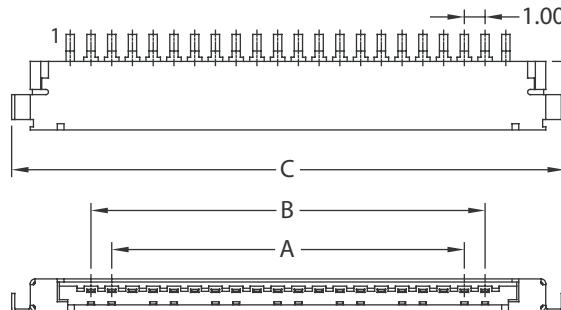

PART NO.	Dimensions		
	A	B	C
1002MR-20TW-U	19.00	21.00	26.65
1002MR-30TW-U	29.00	31.00	36.65

**Part No.:1002MR-XXTW-U**

