

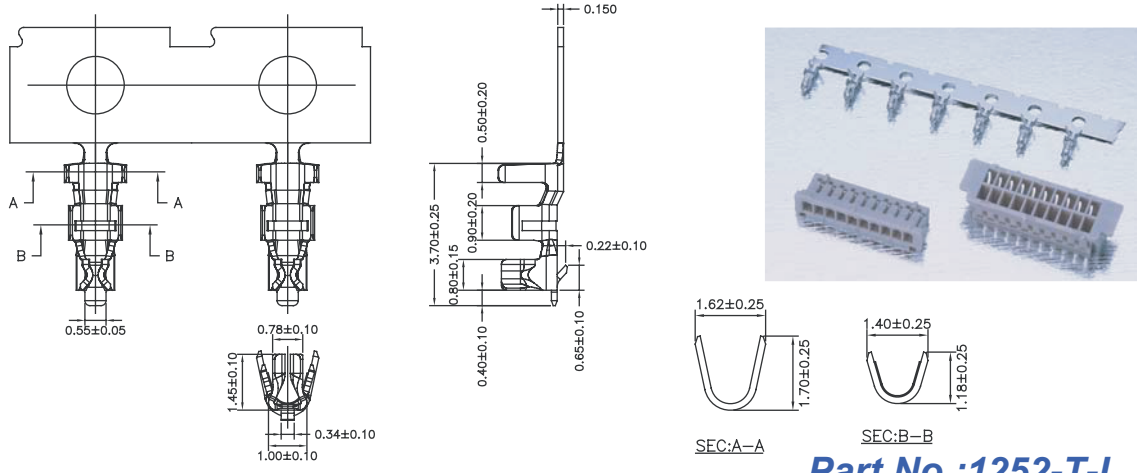

1.25mm TERMINAL / HOUSING



Part No.:1252-T-L

Wire Range	Insulation O.D.	Material	Finish	Qty/reel
AWG#26-#30	1.00mm(max)	Phosphor Bronze	Tin-plated	10,000pcs

SPECIFICATIONS
 Current Rating: 1A AC,DC
 Voltage Rating: 100V AC,DC
 Temperature Range: -25°C ~ +85°C
 Contact Resistance: 20mΩ Max.
 Insulation Resistance: 100MΩ Min.
 Withstanding Voltage: 500V AC/minute
 Material: Nylon 66,UL94V-0
 Pantone Color: 7529C~7530C

PART NO.	Dimensions	
	A	B
1252H-205W-L	5.00	10.40
1252H-207W-L	7.50	12.90
1252H-210W-L	11.25	16.65
1252H-215W-L	17.50	22.90
1252H-220W-L	23.75	29.15

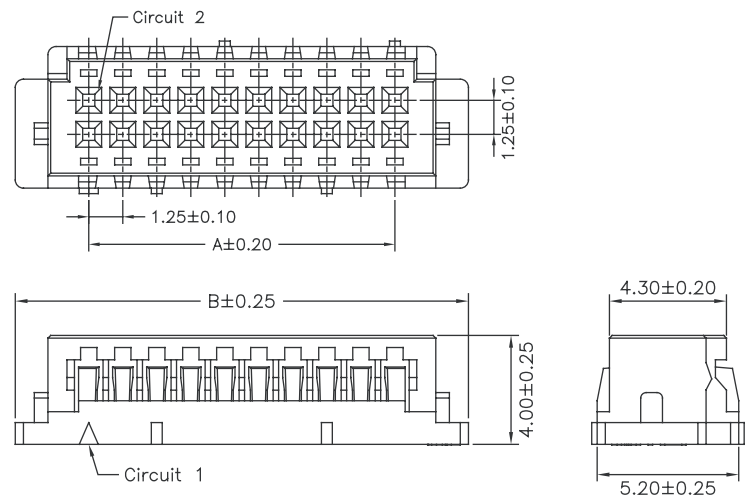

Part No.:1252H-2XXW-L

SPECIFICATIONS
 Current Rating: 1A AC,DC
 Voltage Rating: 100V AC,DC
 Temperature Range: -25°C ~ +85°C
 Contact Resistance: 20 mΩ Max.
 Insulation Resistance: 100MΩ Min.
 Withstanding Voltage: 500V AC/minute
 Material: Nylon 66,UL94V-0
 Pantone Color: 7529C~7530C

PART NO.	Dimensions	
	A	B
1252H-02TW-L	1.25	4.15
1252H-03TW-L	2.50	5.40
1252H-04TW-L	3.75	6.65
1252H-05TW-L	5.00	7.90
1252H-06TW-L	6.25	9.15
1252H-07TW-L	7.50	10.40
1252H-08TW-L	8.75	11.65
1252H-09TW-L	10.00	12.90
1252H-10TW-L	11.25	14.15
1252H-11TW-L	12.50	15.40
1252H-12TW-L	13.75	16.65
1252H-13TW-L	15.00	17.90
1252H-14TW-L	16.25	19.15
1252H-15TW-L	17.50	20.40

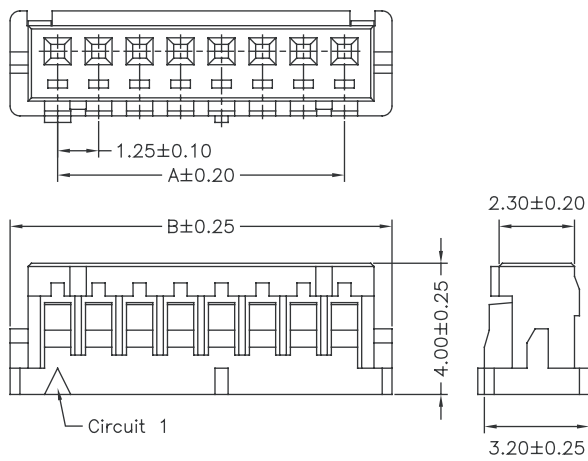

Part No.:1252H-1XXW-L



1.25mm WAFER RIGHT ANGLE / STRAIGHT TYPE

SPECIFICATIONS

Current Rating: 1A AC,DC
Voltage Rating: 100V AC,DC
Temperature Range: $-25^{\circ}\text{C} \sim +85^{\circ}\text{C}$
Contact Resistance: 20m Ω Max.
Insulation Resistance: 100M Ω Min.
Withstanding Voltage: 500V AC/minute
Pin Material: Brass/Tin-plated
Material: Nylon 66,UL94V-0
Pantone Color: 7529C~7530C

PART NO.	Dimensions	
	A	B
1252R-02TW-L	1.25	3.75
1252R-03TW-L	2.50	5.00
1252R-04TW-L	3.75	6.25
1252R-05TW-L	5.00	7.50
1252R-06TW-L	6.25	8.75
1252R-07TW-L	7.50	10.00
1252R-08TW-L	8.75	11.25
1252R-09TW-L	10.00	12.50
1252R-10TW-L	11.25	13.75
1252R-11TW-L	12.50	15.00
1252R-12TW-L	13.75	16.25
1252R-13TW-L	15.00	17.50
1252R-14TW-L	16.25	18.75
1252R-15TW-L	17.50	20.00

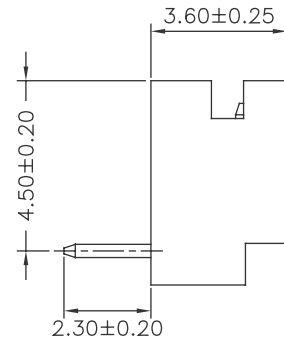
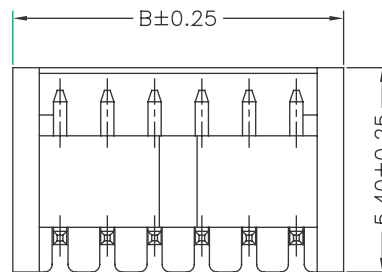
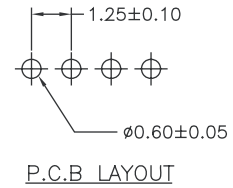
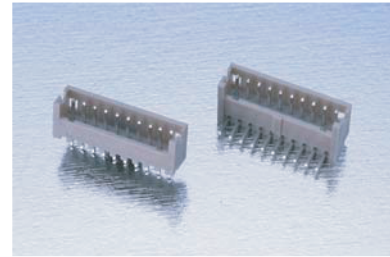
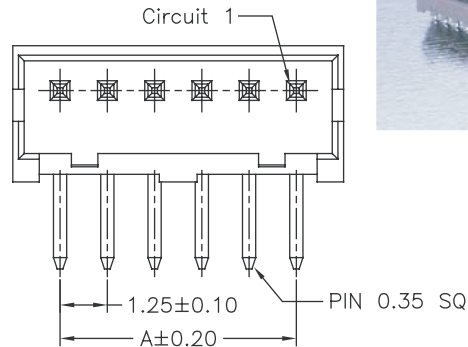

Part No.:1252R-XXTW-L

SPECIFICATIONS

Current Rating: 1A AC,DC
Voltage Rating: 100V AC,DC
Temperature Range: $-25^{\circ}\text{C} \sim +85^{\circ}\text{C}$
Contact Resistance: 20m Ω Max.
Insulation Resistance: 100M Ω Min.
Withstanding Voltage: 500V AC/minute
Pin Material: Brass/Tin-plated
Material: Nylon 66,UL94V-0
Pantone Color: 7529C~7530C

PART NO.	Dimensions	
	A	B
1252S-02TW-L	1.25	3.75
1252S-03TW-L	2.50	5.00
1252S-04TW-L	3.75	6.25
1252S-05TW-L	5.00	7.50
1252S-06TW-L	6.25	8.75
1252S-07TW-L	7.50	10.00
1252S-08TW-L	8.75	11.25
1252S-09TW-L	10.00	12.50
1252S-10TW-L	11.25	13.75
1252S-11TW-L	12.50	15.00
1252S-12TW-L	13.75	16.25
1252S-13TW-L	15.00	17.50
1252S-14TW-L	16.25	18.75
1252S-15TW-L	17.50	20.00

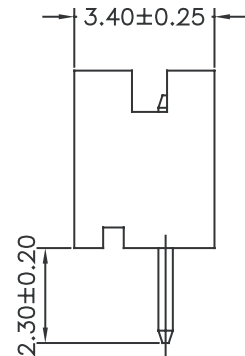
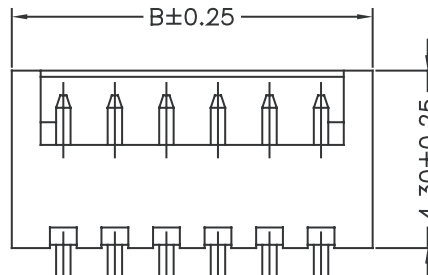
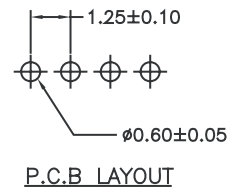
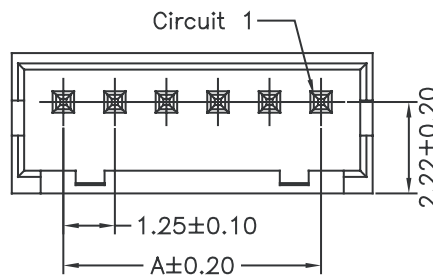

PIN 0.35 SQ

Part No.:1252S-XXTW-L



1.25mm WAFER SMT & SMT R/A TYPE

SPECIFICATIONS

Current Rating: 1A AC,DC
 Voltage Rating: 100V AC,DC
 Temperature Range: -25°C ~ +85°C
 Contact Resistance: 20mΩ Max.
 Insulation Resistance: 100MΩ Min.
 Withstanding Voltage: 500V AC/minute
 Pin Material: Brass/Tin-plated
 Solder Tabs: Brass/Tin-plated
 Cap: Nylon 6T,UL94V-0,Natural(Beige)
 Wafer: Nylon 6T,UL94V-0
 Color: Natural(Beige)

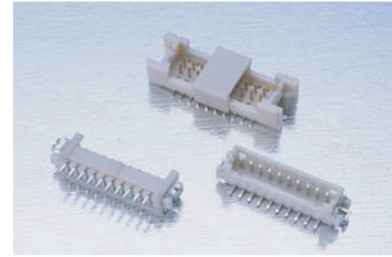
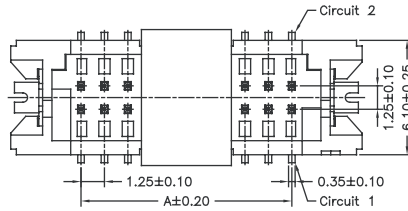

PART NO.	Dimensions	
	A	B
1252MS-205TW-U	5.00	12.50
1252MS-207TW-U	7.50	15.00
1252MS-210TW-U	11.25	18.75
1252MS-215TW-U	17.50	25.00
1252MS-220TW-U	23.75	31.25

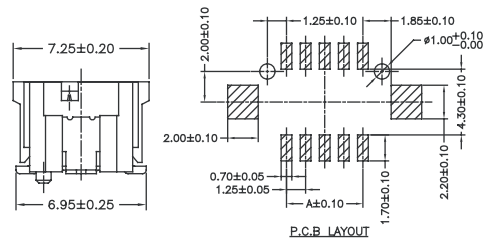
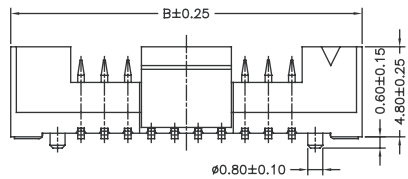

Part No.:1252MS-2XXTW-U

SPECIFICATIONS

Current Rating: 1A AC,DC
 Voltage Rating: 100V AC,DC
 Temperature Range: -25°C ~ +85°C
 Contact Resistance: 20mΩ Max.
 Insulation Resistance: 100MΩ Min.
 Withstanding Voltage: 500V AC/minute
 Pin Material: Brass/Tin-plated
 Solder Tabs: Phosphor Bronze/Tin-plated
 Cap: Nylon 6T,UL94V-0,Natural(Beige)
 Wafer: Nylon 6T,UL94V-0
 Color: Natural(Beige)

PART NO.	Dimensions		
	A	B	C
1252MS-102TW-U	1.25	4.15	6.25
1252MS-103TW-U	2.50	5.40	7.50
1252MS-104TW-U	3.75	6.65	8.75
1252MS-105TW-U	5.00	7.90	10.00
1252MS-106TW-U	6.25	9.15	11.25
1252MS-107TW-U	7.50	10.40	12.50
1252MS-108TW-U	8.75	11.65	13.75
1252MS-109TW-U	10.00	12.90	15.00
1252MS-110TW-U	11.25	14.15	16.25
1252MS-111TW-U	12.50	15.40	17.50
1252MS-112TW-U	13.75	16.65	18.75
1252MS-113TW-U	15.00	17.90	20.00
1252MS-114TW-U	16.25	19.15	21.25
1252MS-115TW-U	17.50	20.40	22.50

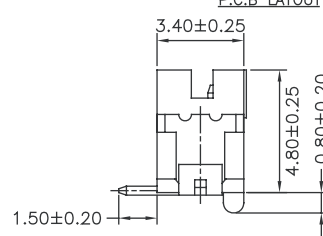
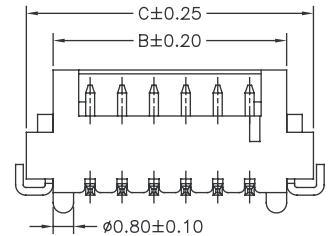
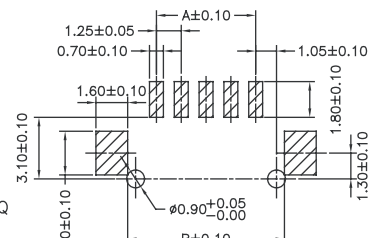
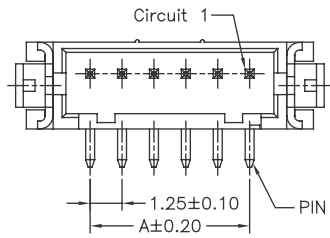

Part No.:1252MS-1XXTW-U

SPECIFICATIONS

Current Rating: 1A AC,DC
 Voltage Rating: 100V AC,DC
 Temperature Range: -25°C ~ +85°C
 Contact Resistance: 20mΩ Max.
 Insulation Resistance: 100MΩ Min.
 Withstanding Voltage: 500V AC/minute
 Pin Material: Brass/Tin-plated
 Solder Tabs: Phosphor Bronze/Tin-plated
 Cap: Nylon 6T,UL94V-0,Natural(Beige)
 Wafer: Nylon 6T,UL94V-0
 Color: Natural(Beige)

PART NO.	Dimensions		
	A	B	C
1252MR-02TW-U	1.25	4.15	6.25
1252MR-03TW-U	2.50	5.40	7.50
1252MR-04TW-U	3.75	6.65	8.75
1252MR-05TW-U	5.00	7.90	10.00
1252MR-06TW-U	6.25	9.15	11.25
1252MR-07TW-U	7.50	10.40	12.50
1252MR-08TW-U	8.75	11.65	13.75
1252MR-09TW-U	10.00	12.90	15.00
1252MR-10TW-U	11.25	14.15	16.25
1252MR-11TW-U	12.50	15.40	17.50
1252MR-12TW-U	13.75	16.65	18.75
1252MR-13TW-U	15.00	17.90	20.00
1252MR-14TW-U	16.25	19.15	21.25
1252MR-15TW-U	17.50	20.40	22.50

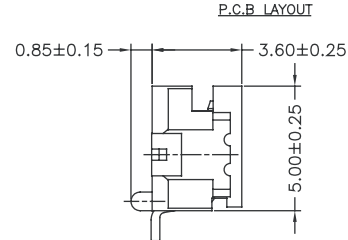
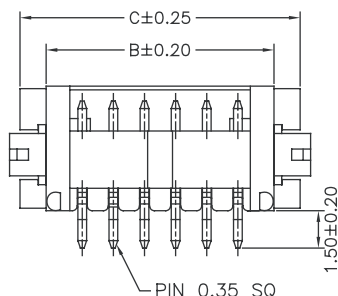
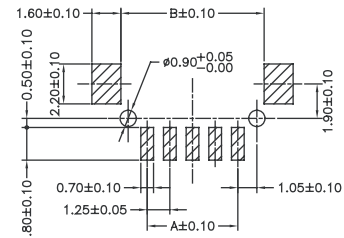
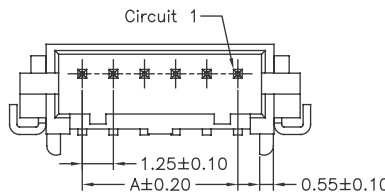

Part No.:1252MR-XXTW-U