

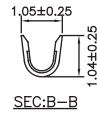

1.25mm Terminal / Housing / Wafer SMT R/A Type

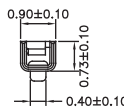
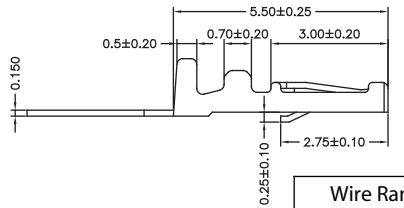
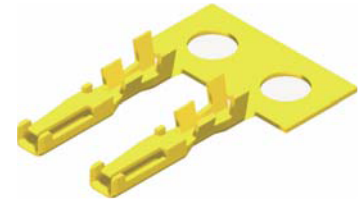
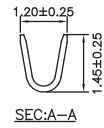
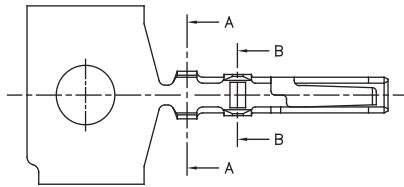

Part No.:1254-T-L

Wire Range	Insulation O.D.	Material	Finish
AWG#28-#32	1.00mm(max)	Phosphor Bronze	Gold-plated

Specifications

Current Rating: 1A AC,DC
 Voltage Rating: 125V AC,DC
 Temperature Range: -25°C to +85°C
 Contact Resistance: 20mΩ Max
 Insulation Resistance: 100MΩ Min
 Withstanding Voltage: 500V AC/minute
 Material:Nylon 66,UL94V-0

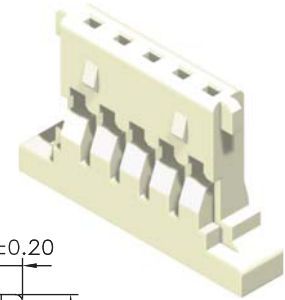
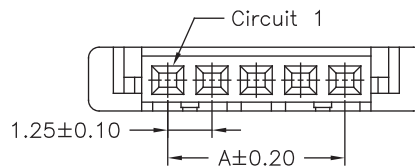

Part No.	Dimensions		
	A	B	C
1254H-02W-L	1.25	2.72	5.72
1254H-03W-L	2.50	3.97	6.97
1254H-04W-L	3.75	5.22	8.22
1254H-05W-L	5.00	6.47	9.47
1254H-06W-L	6.25	7.72	10.72
1254H-07W-L	7.50	8.97	11.97
1254H-08W-L	8.75	10.22	13.22
1254H-09W-L	10.00	11.47	14.47
1254H-10W-L	11.25	12.72	15.72
1254H-11W-L	12.50	13.97	16.97
1254H-12W-L	13.75	15.22	18.22
1254H-14W-L	16.25	17.72	20.72
1254H-15W-L	17.50	18.97	21.97
1254H-16W-L	18.75	20.22	23.22
1254H-20W-L	23.75	25.22	28.22
1254H-30W-L	36.25	37.72	40.72

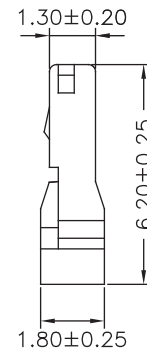
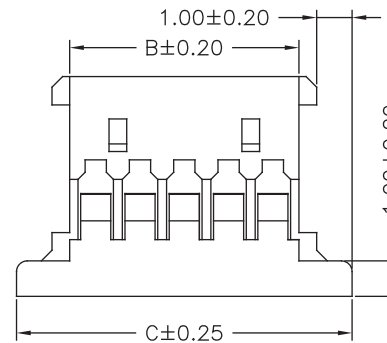

Part No.:1254H-XXW-L

Specifications

Current Rating: 1A AC,DC
 Voltage Rating: 125V AC,DC
 Temperature Range: -25°C to +85°C
 Contact Resistance: 20mΩ Max
 Insulation Resistance: 100MΩ Min
 Withstanding Voltage: 500V AC/minute
 Terminal: Brass / Gold Plated
 Solder Tabs: Brass / Tin Plated
 Material:Nylon 6T,UL94V-0

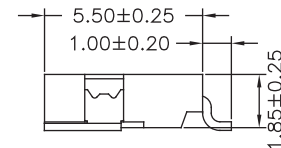
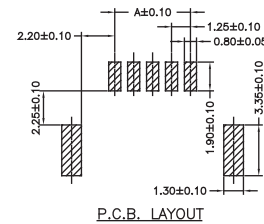
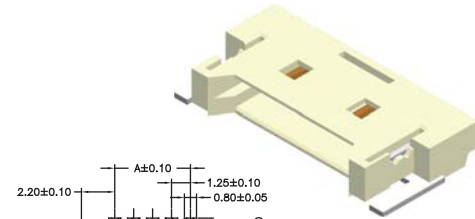
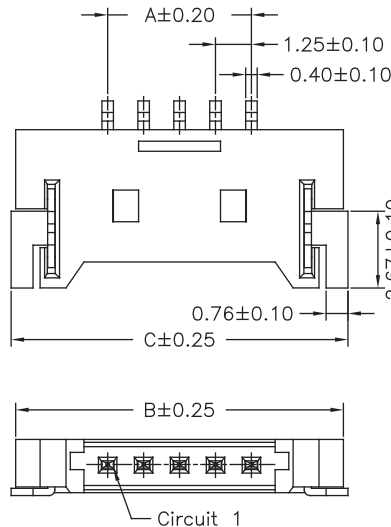

Part No.	Dimensions		
	A	B	C
1254MR-02GW-U	1.25	7.65	7.97
1254MR-03GW-U	2.50	8.90	9.22
1254MR-04GW-U	3.75	10.15	10.47
1254MR-05GW-U	5.00	11.40	11.72
1254MR-06GW-U	6.25	12.65	12.97
1254MR-07GW-U	7.50	13.90	14.22
1254MR-08GW-U	8.75	15.15	15.47
1254MR-09GW-U	10.00	16.40	16.72
1254MR-10GW-U	11.25	17.65	17.97
1254MR-11GW-U	12.50	18.90	19.22
1254MR-12GW-U	13.75	20.15	20.47
1254MR-14GW-U	16.25	22.65	22.97
1254MR-15GW-U	17.50	23.90	24.22
1254MR-16GW-U	18.75	25.15	25.47
1254MR-20GW-U	23.75	30.15	30.47
1254MR-30GW-U	36.25	42.65	42.97

Part No.:1254MR-XXGW-U