

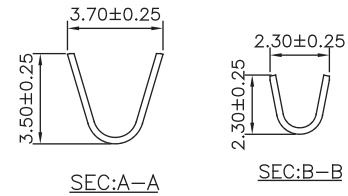

5.08mm Terminal / Housing

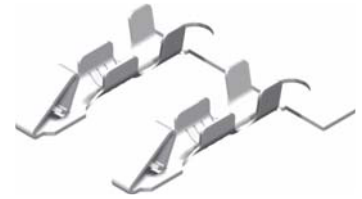
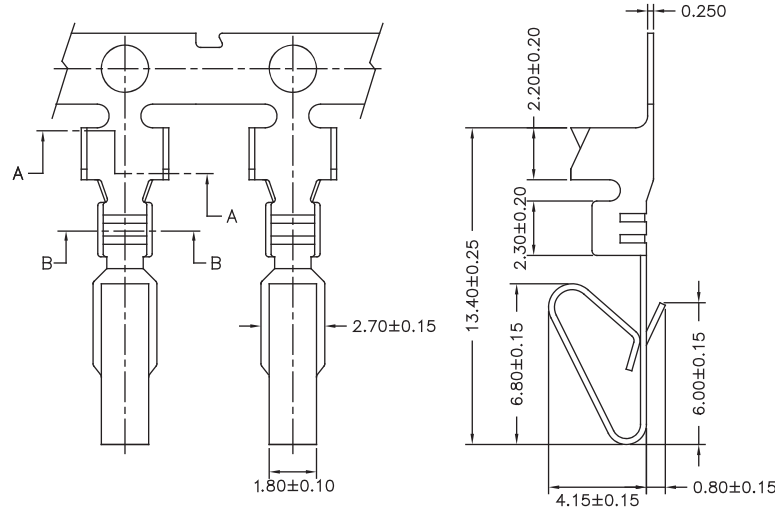

Part No.:3961-T-L

Part No.	Wire Range	Insulation O.D.	Material	Finish
3961-TTB-L	AWG#18-#24	2.80mm(max)	Brass	Tin Plated
3961-TGB-L	AWG#18-#24	2.80mm(max)	Brass	Gold Plated

Specifications

Current Rating: 7A AC,DC
 Voltage Rating: 250V AC,DC
 Temperature Range: -25°C to +85°C
 Contact Resistance: 10mΩ Max
 Insulation Resistance: 1000MΩ Min
 Withstanding Voltage: 1500V AC/minute
 Material: Nylon 66,UL94V-2



No. of Contacts	Dimensions	
	A	B
02	5.08	10.08
03	10.16	15.16
04	15.24	20.24
05	20.32	25.32
06	25.40	30.40
07	30.48	35.48
08	35.56	40.56
09	40.64	45.64
10	45.72	50.72
11	50.80	55.80
12	55.88	60.88
13	60.96	65.96
14	66.04	71.04
15	71.12	76.12
16	76.20	81.20
17	81.28	86.28
18	86.36	91.36
19	91.44	96.44
20	96.52	101.52

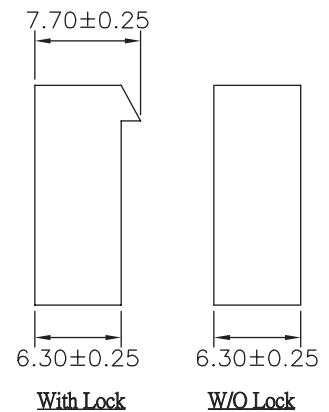
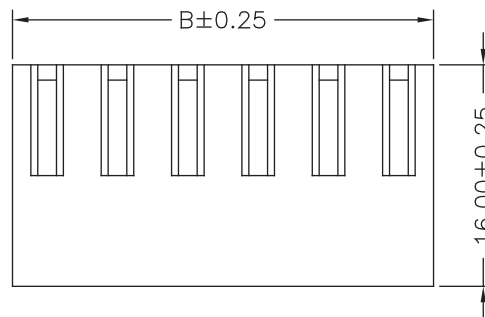
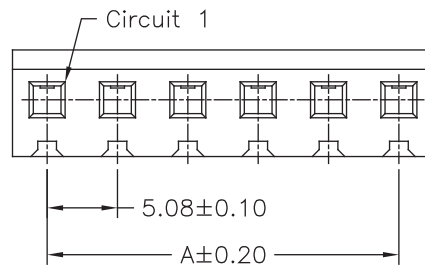

Part No.:5083H-XXW□-L

A: WITH LOCK
 B: W/O LOCK



5.08mm Wafer Right Angle / Straight Type

Specifications

Current Rating: 7A AC,DC
 Voltage Rating: 250V AC,DC
 Temperature Range: -25°C to +85°C
 Contact Resistance: 10mΩ Max
 Insulation Resistance: 1000MΩ Min
 Withstanding Voltage: 1500V AC/minute
 Terminal: Brass / Tin Plated
 Material: Nylon 66,UL94V-2

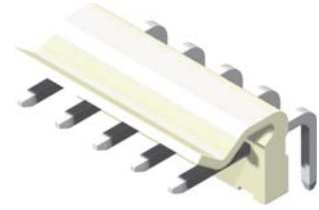

Part No.	Dimensions	
	A	B
5083RA-02TW-L	5.08	10.16
5083RA-03TW-L	10.16	15.24
5083RA-04TW-L	15.24	20.32
5083RA-05TW-L	20.32	25.40
5083RA-06TW-L	25.40	30.48
5083RA-07TW-L	30.48	35.56
5083RA-08TW-L	35.56	40.64
5083RA-09TW-L	40.64	45.72
5083RA-10TW-L	45.72	50.80
5083RA-11TW-L	50.80	55.88
5083RA-12TW-L	55.88	60.96
5083RA-13TW-L	60.96	66.04
5083RA-14TW-L	66.04	71.12
5083RA-15TW-L	71.12	76.20
5083RA-16TW-L	76.20	81.28
5083RA-17TW-L	81.28	86.36
5083RA-18TW-L	86.36	91.44
5083RA-19TW-L	91.44	96.52
5083RA-20TW-L	96.52	101.60

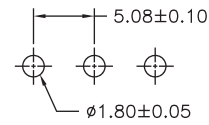
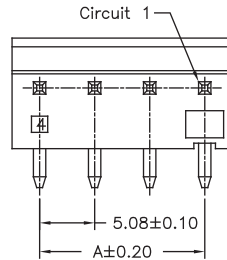

P.C.B. LAYOUT

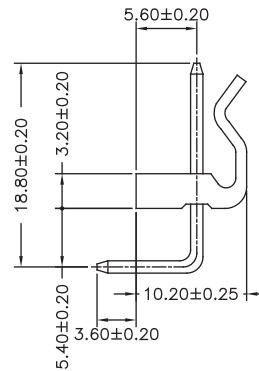
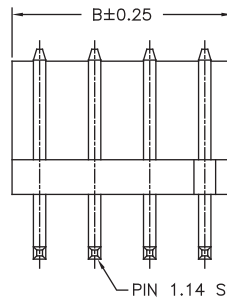

Part No.:5083RA-XXTW-L

Specifications

Current Rating: 7A AC,DC
 Voltage Rating: 250V AC,DC
 Temperature Range: -25°C to +85°C
 Contact Resistance: 10mΩ Max
 Insulation Resistance: 1000MΩ Min
 Withstanding Voltage: 1500V AC/minute
 Terminal: Brass / Tin Plated
 Material: Nylon 66,UL94V-2

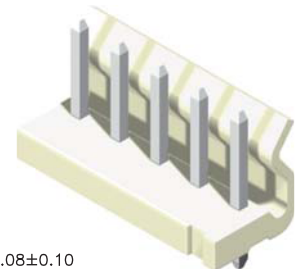

Part No.	Dimensions	
	A	B
5083SA-02TW-L	5.08	10.16
5083SA-03TW-L	10.16	15.24
5083SA-04TW-L	15.24	20.32
5083SA-05TW-L	20.32	25.40
5083SA-06TW-L	25.40	30.48
5083SA-07TW-L	30.48	35.56
5083SA-08TW-L	35.56	40.64
5083SA-09TW-L	40.64	45.72
5083SA-10TW-L	45.72	50.80
5083SA-11TW-L	50.80	55.88
5083SA-12TW-L	55.88	60.96
5083SA-13TW-L	60.96	66.04
5083SA-14TW-L	66.04	71.12
5083SA-15TW-L	71.12	76.20
5083SA-16TW-L	76.20	81.28
5083SA-17TW-L	81.28	86.36
5083SA-18TW-L	86.36	91.44
5083SA-19TW-L	91.44	96.52
5083SA-20TW-L	96.52	101.60

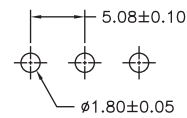
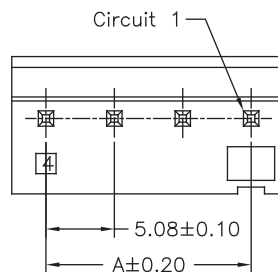

P.C.B. LAYOUT

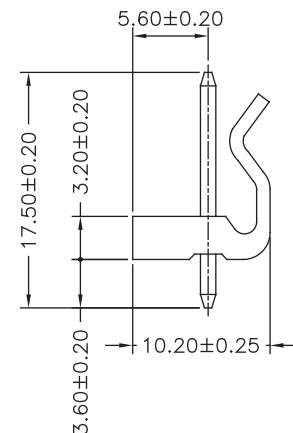
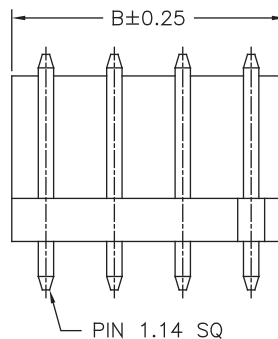

Part No.:5083SA-XXTW-L



5.08mm Wafer W/O Ramp Right Angle / Straight Type

Specifications

Current Rating: 7A AC,DC
 Voltage Rating: 250V AC,DC
 Temperature Range: -25°C to +85°C
 Contact Resistance: 10mΩ Max
 Insulation Resistance: 1000M
 Withstanding Voltage: 1500V AC/minute
 Terminal: Brass / Tin Plated
 Material: Nylon 66,UL94V-2

Part No.	Dimensions	
	A	B
5083RB-02TW-L	5.08	10.16
5083RB-03TW-L	10.16	15.24
5083RB-04TW-L	15.24	20.32
5083RB-05TW-L	20.32	25.40
5083RB-06TW-L	25.40	30.48
5083RB-07TW-L	30.48	35.56
5083RB-08TW-L	35.56	40.64
5083RB-09TW-L	40.64	45.72

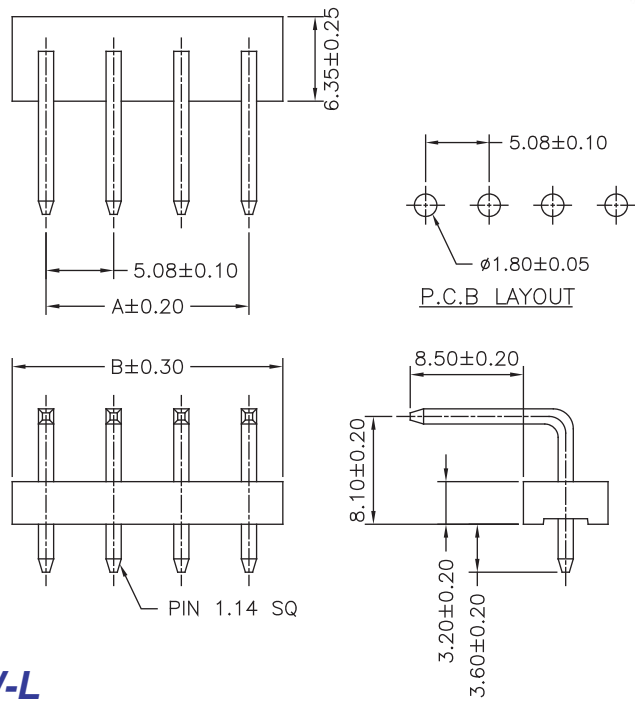

Part No.:5083RB-XXTW-L

Specifications

Current Rating: 7A AC,DC
 Voltage Rating: 250V AC,DC
 Temperature Range: -25°C to +85°C
 Contact Resistance: 10mΩ Max
 Insulation Resistance: 1000M
 Withstanding Voltage: 1500V AC/minute
 Terminal: Brass / Tin Plated
 Material: Nylon 66,UL94V-2

Part No.	Dimensions	
	A	B
5083RB-02TW-L	5.08	10.16
5083RB-03TW-L	10.16	15.24
5083RB-04TW-L	15.24	20.32
5083RB-05TW-L	20.32	25.40
5083RB-06TW-L	25.40	30.48
5083RB-07TW-L	30.48	35.56
5083RB-08TW-L	35.56	40.64
5083RB-09TW-L	40.64	45.72

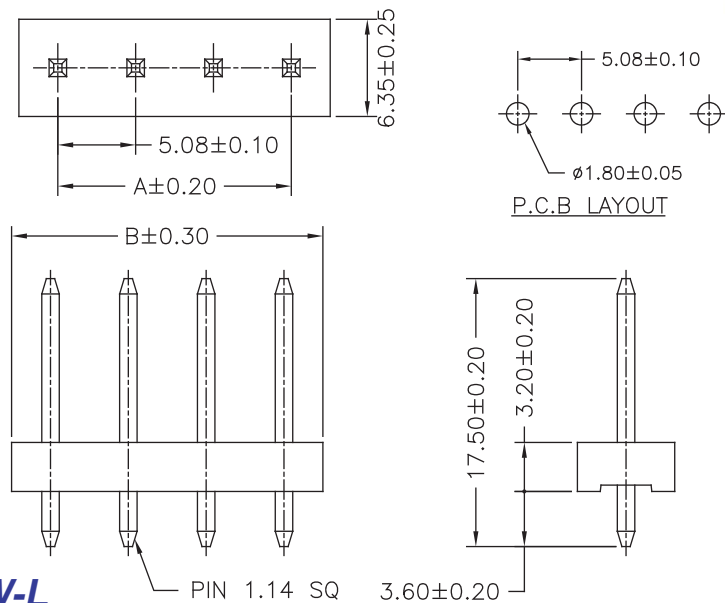

Part No.:5083SB-XXTW-L